

# ADELAIDE AIRPORT

NEW MULTI-LEVEL CAR PARK AND PEDESTRIAN PLAZA

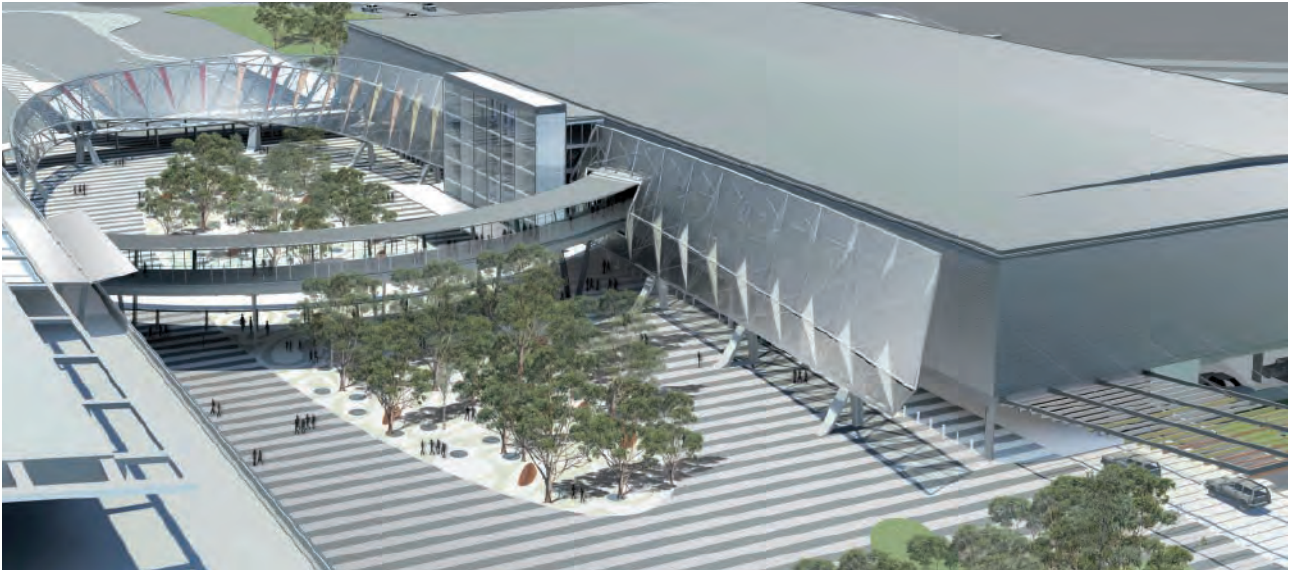

[www.adelaideairport.com.au](http://www.adelaideairport.com.au)



# FAST FACTS

## ADELAIDE AIRPORT MULTI-LEVEL CAR PARK AND PEDESTRIAN PLAZA

- Project value:** \$100 million
- Description:** The multi-level car park will provide short-term parking for 2,000 public and car rental vehicles. It will have direct access to T1 (Terminal 1) via a pedestrian plaza and link bridge. The passenger pick-up and drop-off points will be located between the new car park and pedestrian plaza. Adelaide Airport's road system will also be re-aligned to cater for the new development.
- Location:** The multi-level car park will be positioned approximately 50 metres north of T1. The pedestrian plaza is between the new car park and T1, roughly the location of the existing short-term car park.
- Features include:** In addition to short-term parking, the new multi-level car park and pedestrian plaza will include facilities for rental cars, taxi pick up, bus parking, food and beverage outlets and small retail outlets.
- Capacity:** The 2,000 space car park is more than double the size of the existing short-term car park. It is expected to facilitate approximately 7,000 vehicle entries per day.
- Dimensions:**
- |         |                      |
|---------|----------------------|
| Length: | 151 metres           |
| Width:  | 81 metres            |
| Height: | 18 metres - 5 levels |
- Economic impact:** The construction phase of the project will directly and indirectly create 596 jobs, generating an economic benefit of \$87.2 million per annum. Once operational, the direct and indirect employment benefit will be 87 jobs per year with an economic benefit of \$12.8 million per annum.
- Project timing:**
- |                |                                       |
|----------------|---------------------------------------|
| January 2011:  | Construction commenced                |
| April 2011:    | Temporary road diversions take effect |
| May 2012:      | Car park opens                        |
| November 2012: | Pedestrian plaza opens                |