

# Taking our world class passenger experience even higher



**Terminal  
Expansion  
Project**

# Adelaide Airport: Expanding to meet growing needs



Since the existing terminal was opened in 2005, overall passenger numbers have increased by close to 50 per cent. International passenger numbers alone have almost tripled over the same period.

The \$165 million expansion of the main terminal will significantly upgrade international arrivals and departures, and create more retail and dining options for both domestic and international travellers.

---

# Retail and dining experiences like never before



Total retail footprint increase by more than 80% to

**7,257 sqm**

(domestic and international)

Project construction contributing \$167 million to Gross State Product

Expansion of terminal footprint: 16,500sqm

Larger retail and dining precinct within international departures

Additional terminal refurbishment footprint: 18,400sqm

# A truly international travel experience



**Key focus of the expansion is on improving the arrivals and departures experience for international passengers**

**Adelaide Airport's first VIP facilities for International arrivals and departures**

---

**New common user lounge for international departures**

---

**Relocation of the Virgin Australia Lounge**

---

# Creating memorable journeys through better customer experience



**Travellers can look forward to an expanded duty free precinct for international arrivals and departures**

---

**Improved international boarding gate and queuing system**

---

**Gate 18 to be dedicated international departures gate**

---

**Expanded international security screening**

---

**Expansion to emigration and security screening space and relocated from Level 2 (check-in level) to Level 1**

---

**Improved family facilities including play area in international departures**

---

**Improved accessible facilities for people with a disability including post screening assistance animal relief area and Changing Places facilities**

---

# The terminal expansion will ensure Adelaide Airport provides the highest level of customer experience for all travellers well into the future



Workforce to reach 200 people at peak construction

---



The terminal expansion is by far the biggest infrastructure project at Adelaide Airport since the completion of the existing terminal in 2005. The project completion date is 2021.

---

“Our aim is to provide a seamless, connected experience from the time you drive into the airport until you board your aircraft, and vice versa.”

— Mark Young, MD, Adelaide Airport

### Level 0

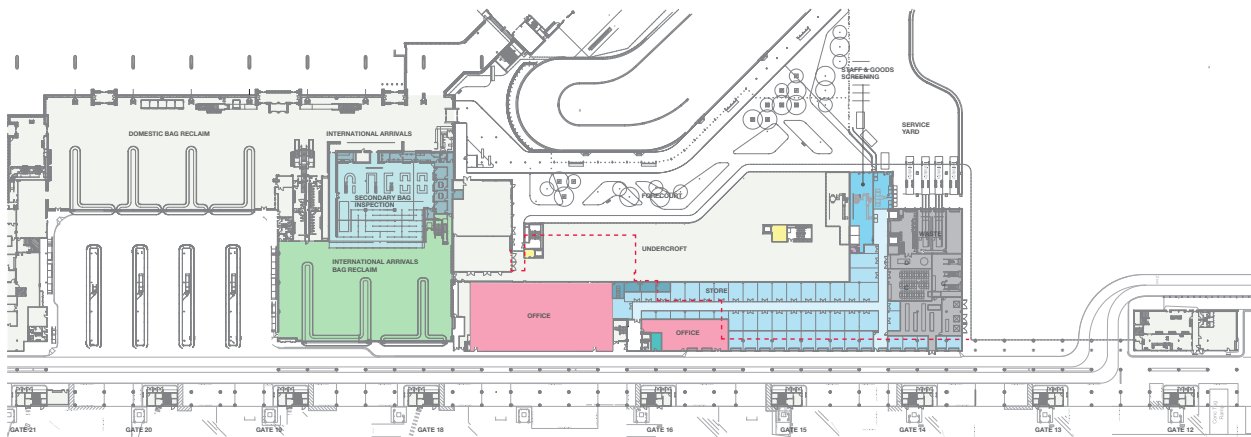

### Level 1

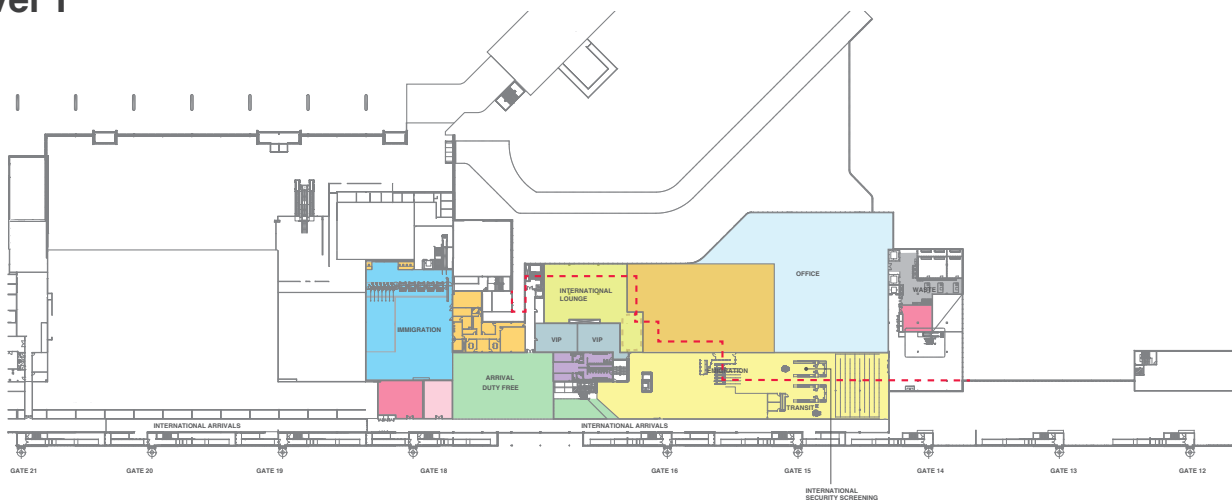

### Level 2

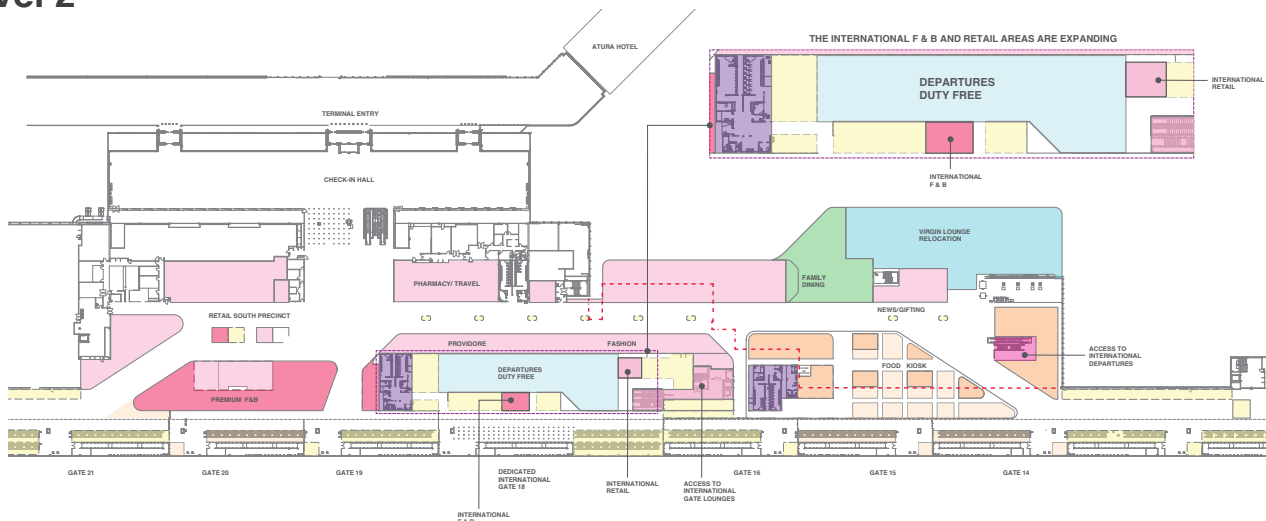

--- CURRENT BUILDING FOOTPRINT



## **Terminal Expansion Project**

For further details, please contact:

**Amy Mitchell**  
**Stakeholder Manager - Terminal Expansion Project**

**P: 08 8308 9111**

**E: [amitchell@aal.com.au](mailto:amitchell@aal.com.au)**